

IT IS A VIOLATION OF LAW FOR ANY PERSON, UNLESS THEY ARE ACTING UNDER THE DIRECTION OF A LICENSED PROFESSIONAL ENGINEER, ARCHITECT, LANDSCAPE ARCHITECT, OR LAND SURVEYOR, TO ALTER AN ITEM IN ANY WAY. IF AN ITEM BEARING THE STAMP OF A LICENSED PROFESSIONAL IS ALTERED, THE ALTERING ENGINEER, ARCHITECT, LANDSCAPE ARCHITECT, OR LAND SURVEYOR SHALL STAMP THE DOCUMENT AND INCLUDE THE NOTATION "ALTERED BY" FOLLOWED BY THEIR SIGNATURE, THE DATE OF SUCH ALTERATION, AND A SPECIFIC DESCRIPTION OF THE ALTERATION.

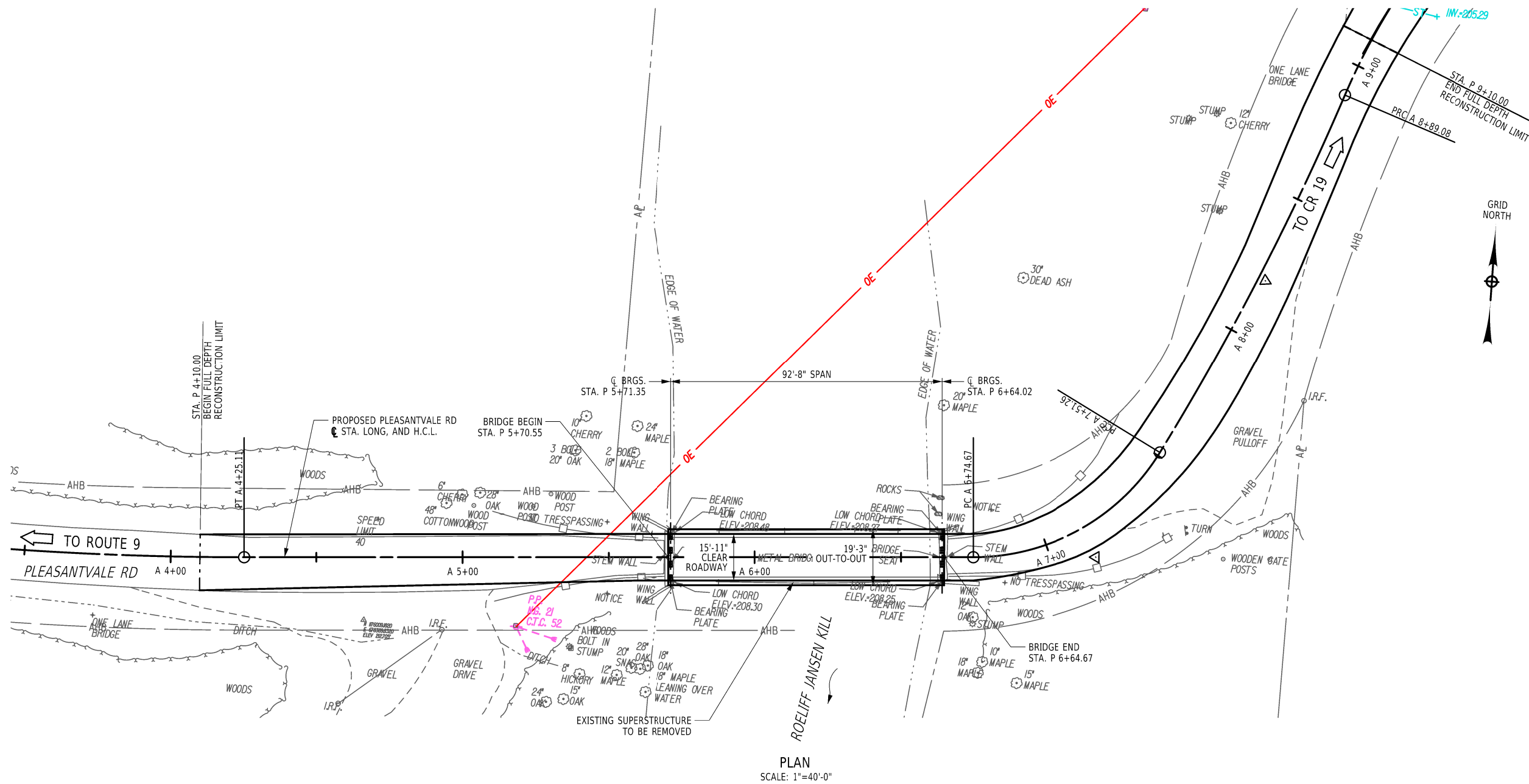

PLAN  
 SCALE: 1"=40'-0"

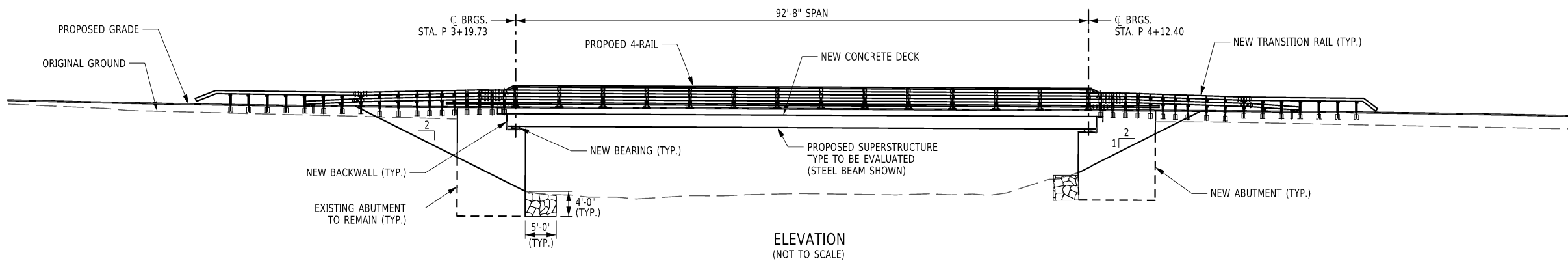

ELEVATION  
 (NOT TO SCALE)

LEGEND:  
 [Pattern Box] MEDIUM STONE FILL

PROGRESS  
 PRINT  
 NOT FOR  
 CONSTRUCTION

NO.	REVISION	DATE	BY

PREPARED FOR:  
 COLUMBIA COUNTY DEPARTMENT  
 OF PUBLIC WORKS  
 PO BOX 324  
 HUDSON NY 12534

DESIGNED: J.O.  
 DRAWN BY: K.H.D. | CHECKED: L.A.S.

SUPERSTRUCTURE REPLACEMENT  
 OF STALL BRIDGE OVER ROELIFF JANSEN KILL  
 COLUMBIA COUNTY, NEW YORK

GENERAL PLAN & ELEVATION  
 ALTERNATIVE 5

DATE: FEBRUARY 2023 | CM No.: 122-294 | SCALE: AS NOTED